

Service & Maintenance Sheet

J0452 Series Coupler (Viton) Without Pump

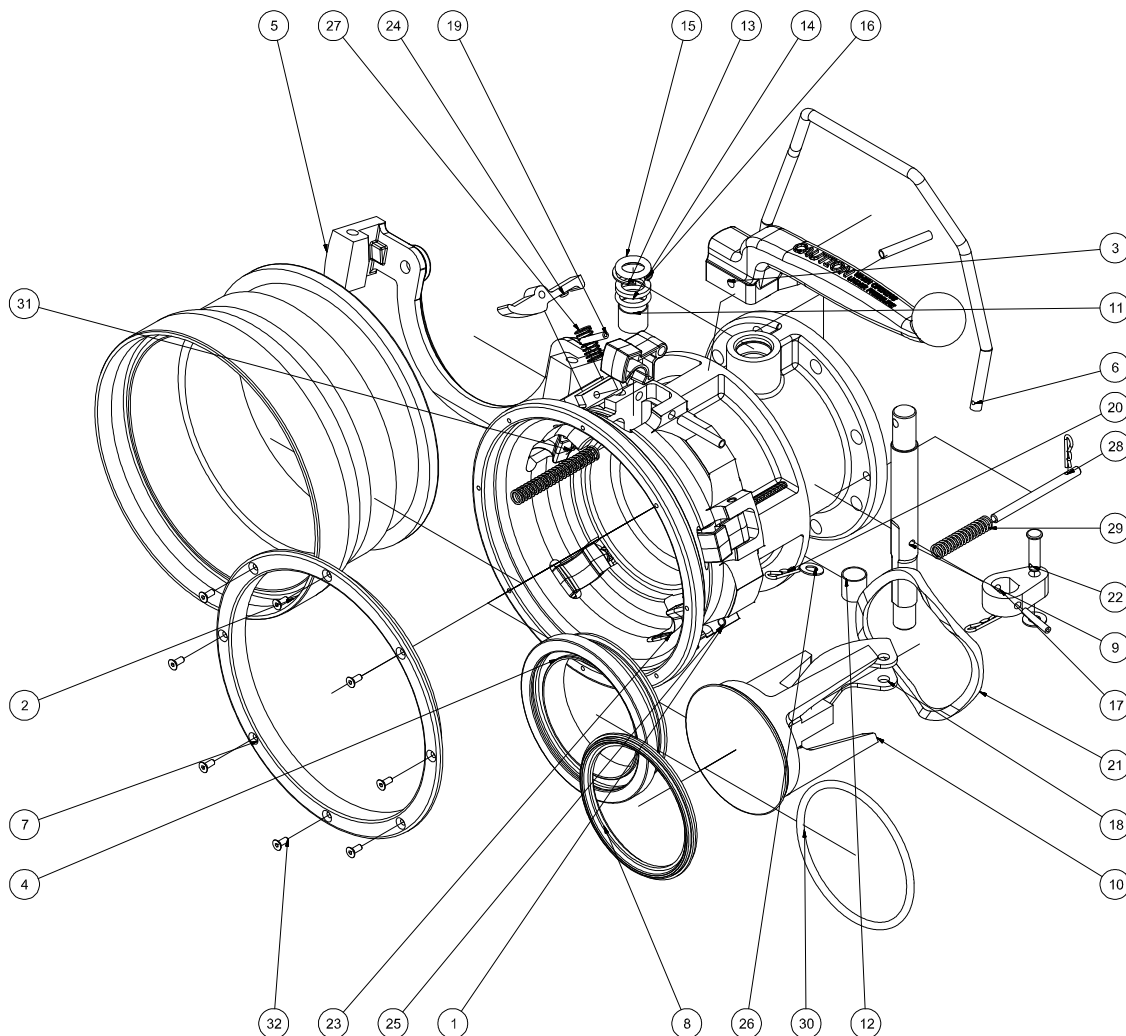

Coupler

NOTE: API couplers should always be used in conjunction with primary shutoff system such as a meter with preset valve. A relief valve must be provided for the trapped product between the primary shutoff and the API coupler.

WARNING care must be taken when manually operating the lugs as the sleeve is under considerable spring pressure. Ensure that nothing will become trapped between the body and sleeve when it moves forward.

IMPORTANT: Before you begin, drain the line of all product. This can be done by depressing the 5 interlock claws on the coupler (23), the safety lug (24) and turning the lever (3).

As a part of a continuous commitment to product development the company reserves the right to alter the specification of its products without prior notice

EMCO WHEATON
A Gardner Denver Product

Channel Road
Westwood Industrial Estate
Margate Kent CT9 4JR
UK
Tel: +44 (0) 1843 221521
Fax: +44 (0) 1843 295444
sales@emcowheaton.co.uk
www.emcowheaton.co.uk



Service & Maintenance Sheet

J0452 Series Coupler (Viton) Without Pump

Coupler

ITEM	QTY	DESCRIPTION	PART NUMBER	MATERIAL
1	1	Body	673262	Aluminum 356-T6
2	1	Sleeve	673257	Aluminum 356-T6
3	1	Lever	673259	Aluminum 356-T6
4	1	Nose Piece	672245	Aluminum-6061
5	1	Retractor Bale	673255	Aluminum 356-T6
6	1	Retractor Handle	673264	Stainless Steel
7	1	Nose Ring	673265	Aluminum 6082-T6
8	1	Nose Seal	672213	Viton
9	1	Shaft	672319	Stainless Steel
10	1	Poppet	672349	Aluminum 356-T6
11	1	Bearing	560594	Plastic
12	1	Bearing	560595	Plastic
13	1	O-Ring	407433	Viton
14	1	Spacer	240805203	Nylon
15	1	O-Ring (Dust Seal)	561320	Buna
16	1	Retaining Ring	408169	Steel
17	1	Link	408254	Stainless Steel
18	2	Bent Link	408262	Stainless Steel
19	2	Spring Pin	561852	Stainless Steel
20	6	Hitch Pin	560489	Stainless Steel
21	1	Wave Spring	564090	Stainless Steel
22	2	Link Pin	408252	Stainless Steel
23	5	Interlock Claw	527071200	Stainless Steel
24	1	Safety Lug	527072201	Stainless Steel
25	6	Roll Pin	470078	Stainless Steel
26	4	M8 Thin Washer	671270	Stainless Steel
27	1	Safety Lug Spring	517002208	Stainless Steel
28	2	Retractor Guide	673241	Stainless Steel
29	2	Retractor Spring	517002203	Stainless Steel
30	1	O-Ring	672741	Viton - PTFE Treated
31	5	Interlock Claw Spring	673269	Stainless Steel
32	8	M4 x 10 Countersunk Screw	617025	Stainless Steel

As a part of a continuous commitment to product development the company reserves the right to alter the specification of its products without prior notice

EMCO WHEATON
A Gardner Denver Product

Sheet 2 of 6
 Sheet Ref. SSJ0452 Series Coupler Without Pump
 Date 01/01/01 Revision 0

Channel Road
 Westwood Industrial Estate
 Margate Kent CT9 4JR
 UK
 Tel: +44 (0) 1843 221521
 Fax: +44 (0) 1843 295444
 sales@emcowheaton.co.uk
 www.emcowheaton.co.uk



Service & Maintenance Sheet

J0452 Series Coupler (Viton) Without Pump

Coupler

Spare Part Kits Available		
Part No	Title	Parts Include
494529	Viton Seal Kit	672213, 672741, 561320, 407433, 564090, 560595, 560594, 470078 (2), 561852 (2)
494532	Nosepiece and Poppet Kit	672245, 672349, 560489 (2), 408252 (2), 470078 (2), 561852 (2)
673293	Claws and Interlock Lug	527071200(5), 527072201, 470078(5), 561852
673294	Nose Ring Kit	673265, 617025 (8)
673295	Kit, J0452 Lever	673259, 470078
672869	Kit, J0451/J0452 Shaft	672319, 470078, 561852, 408169

TO CHANGE THE NOSEPIECE SEAL:

1. Once fully drained, remove coupler from loading arm at flange.

WARNING care must be taken when manually operating the lugs as the sleeve is under considerable spring pressure. Ensure that nothing will become trapped between the body and sleeve when it moves forward.

2. Depress the 5 locking lugs (23) and the interlock lug (24) to allow the sleeve to move forward under spring pressure.

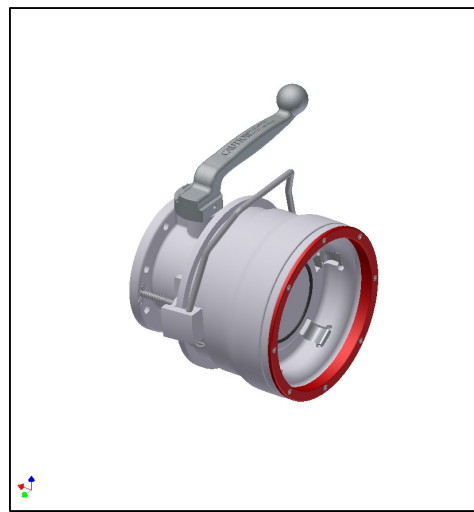
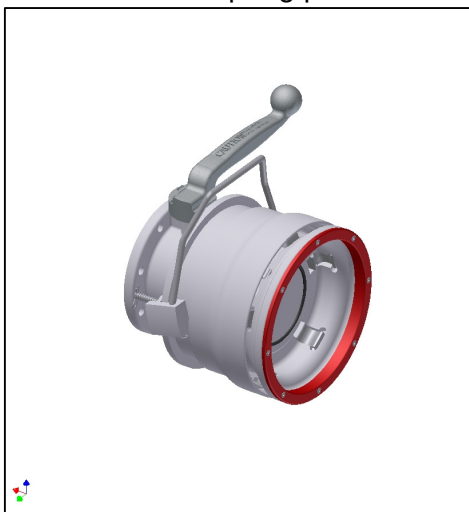

As a part of a continuous commitment to product development the company reserves the right to alter the specification of its products without prior notice

EMCO WHEATON
A Gardner Denver Product

Service & Maintenance Sheet

J0452 Series Coupler (Viton) Without Pump

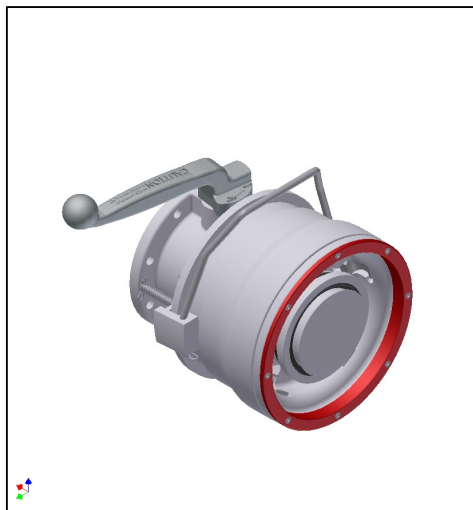

3. Turn the lever (3) to open the coupler to allow access to the poppet linkage assembly. (Poppet linkage assembly consists of the poppet (10), bent links (18) and link pins (22)).

Coupler

4. With no tension on the poppet assembly, use needle nose pliers to remove one set of the hitch pin (20), link pins (22) and washers (26).

Note: The set that is closest to the flange is easiest to access.

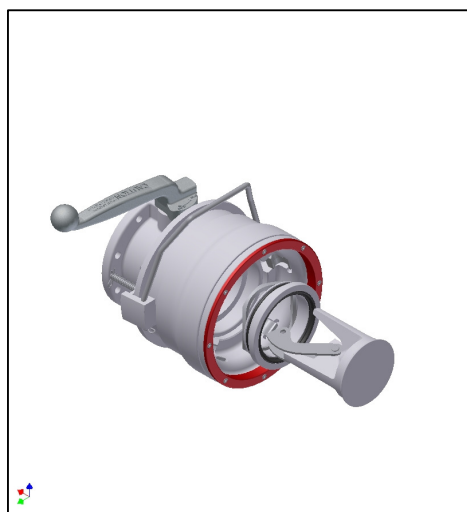

5. After the pin set has been removed, remove poppet assembly from the body bore.
6. Carefully remove the nosepiece (4) and wave spring (21). Do not nick the bore in the process.
7. Without scratching the seal seats on the nosepiece, use a pick to carefully remove nose seal (8) and the o-ring (13).
8. Using a solvent, thoroughly clean the bore and nosepiece seal grooves. Make sure all grit is removed.
9. If shaft seal needs replacing, go to steps 10-17 before reattaching poppet and bent links. If not, than reassemble, reversing the above steps.

As a part of a continuous commitment to product development the company reserves the right to alter the specification of its products without prior notice

EMCO WHEATON
A Gardner Denver Product

Service & Maintenance Sheet

J0452 Series Coupler (Viton) Without Pump

TO CHANGE THE SHAFT O-RING:

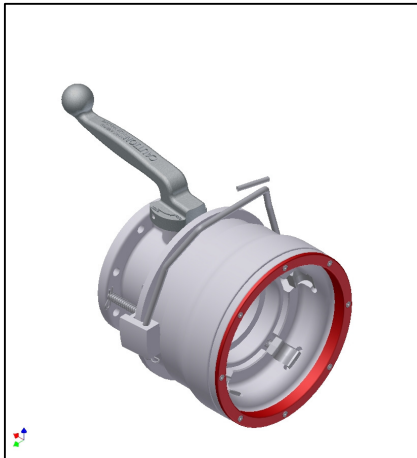

10. Open the coupler (refer to step 2 above) and rotate lever to gain access to roll pin that attaches handle to shaft (25).
11. Using a hammer and punch, remove roll pin (25) from lever (3). Slide lever off the end of the shaft.

12. Remove dust seal (15) with picking tool. Discard dust seal.
13. Remove retaining ring (16) with retaining ring pliers.

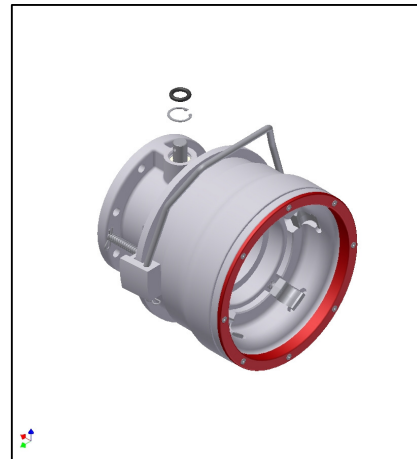

14. Slide shaft out to expose spacer (14) and o-ring (13). Remove spacer and o-ring. Discard o-ring.
15. Lubricate new product seal with Parker Super Lube (or equivalent) and assemble in reverse order. Lubricate new dust seal (15) before installation.

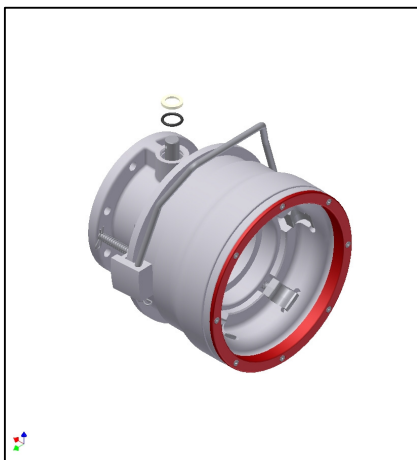

16. Reverse the above process for assembling the stuffing box.
17. Return to Step 9 for assembly of the poppet.

Coupler

As a part of a continuous commitment to product development the company reserves the right to alter the specification of its products without prior notice

EMCO WHEATON
A Gardner Denver Product

Sheet 5 of 6
Sheet Ref. SSJ0452 Series Coupler Without Pump
Date 01/01/01 Revision 0

Channel Road
Westwood Industrial Estate
Margate Kent CT9 4JR
UK
Tel: +44 (0) 1843 221521
Fax: +44 (0) 1843 295444
sales@emcowheaton.co.uk
www.emcowheaton.co.uk



Service & Maintenance Sheet

J0452 Series Coupler (Viton) Without Pump

TO CHANGE THE NOSE RING:

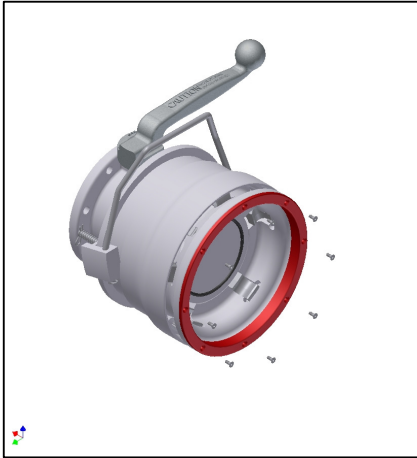

18. Undo the 8 screws (32) on the front of the coupler using a 2.5mm allen key.

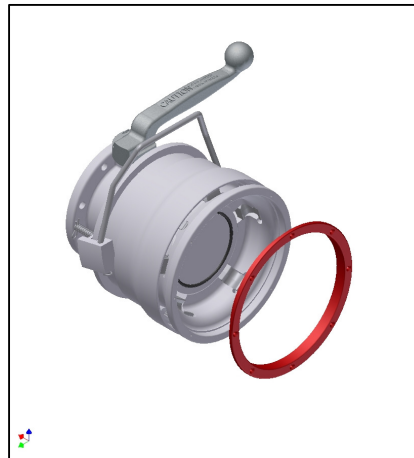

19. Remove the nose ring (7) and discard. If the nose ring is difficult to remove, use a screwdriver to lever the ring off.

20. Replace nose ring and fit new retaining screw. Use one drop of a medium strength thread locking compound such as loctite 241/2/3, on each screw.

Coupler

As a part of a continuous commitment to product development the company reserves the right to alter the specification of its products without prior notice

EMCO WHEATON
A Gardner Denver Product

Sheet 6 of 6
Sheet Ref. SSJ0452 Series Coupler Without Pump
Date 01/01/01 Revision 0

Channel Road
Westwood Industrial Estate
Margate Kent CT9 4JR
UK
Tel: +44 (0) 1843 221521
Fax: +44 (0) 1843 295444
sales@emcowheaton.co.uk
www.emcowheaton.co.uk

